

DOUBLE ROLLER BLIND INSTALLATION INSTRUCTIONS

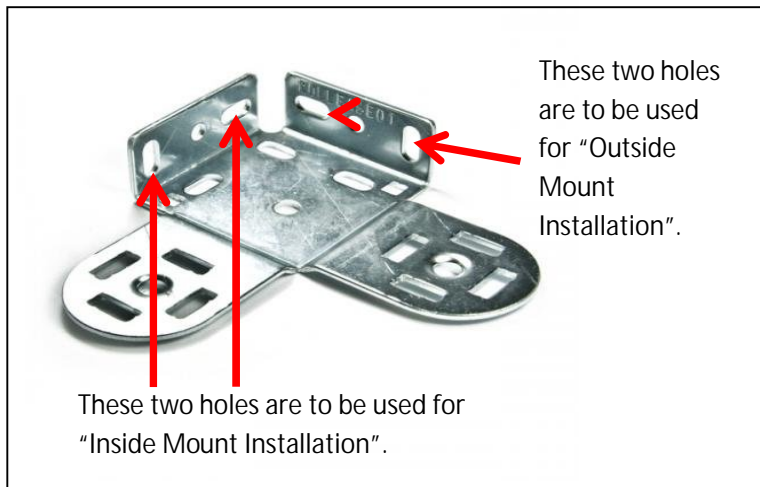

IMPORTANT: The photo on the left hand side is an example of a Left Hand Side Double Bracket. As these blinds come in pairs, they are a mirror image of one another. The Right Hand Side Double Bracket will have installation holes reversed, so the holes on the photo for the Outside Mount Installation will be used for the Inside Mount Installation and the wholes for the Inside Mount Installation will be used for the Outside Mount Installation. The double bracket on the photo is not colour coded. You will have a choice of bracket colours to choose from at the time of your purchase.

IMPORTANT NOTES:

1. Please check that all parts (DOUBLE BRACKET AND CHILD SAFETY DEVICE) have been supplied before you begin to assemble your new Custom Roller Blind.
2. Do not unroll the blind until it is fully installed.
3. The finished blind width is from the outside of the left bracket to the outside of the right bracket.
4. Ensure that the blind is mounted level for correct operation.

INFORMATION REGARDING BLIND FABRIC: "Please be aware that horizontal lines may appear on the roller blind fabric due to packaging. These lines will drop out once the blind has been hanging for a few days."

1. POSITIONING BLINDS

As per your order, determine the correct fitting location.

- 1) Inside the window frame (Inside Mount) or; 2) on the window frame or wall (Outside Mount)

2. INSTALLING MOUNTING BRACKETS

Place the left hand side bracket in the desired location, as per your order i.e. inside mount or outside mount, mark and if necessary pre-drill 2 holes (Pre drilling holes is advisable as it may prevent wood from splitting). After drilling the holes, secure the bracket with screws (See the picture below). Repeat this process for the right hand side.

NOTE: You will need to provide your own screws for bracket installation. The screw size we would normally use is 7G 20-25mm screw size. Also be careful to choose the right screw for the right application i.e. screw for metal, timber, aluminium etc....

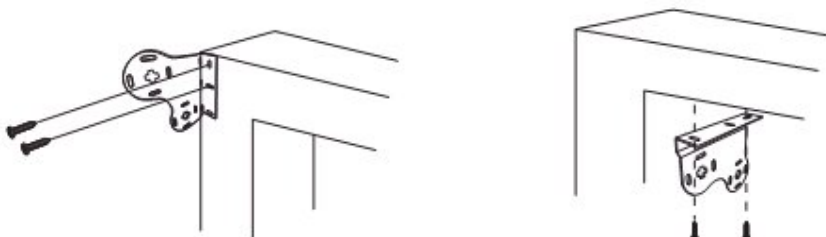

3. ATTACHING THE BLIND TO THE BRACKETS

Insert the PIN mechanism into the PIN hole on the bracket so it is engaged (figure 1). Carefully align the chain control mechanism with the control bracket (figure 2). Push the blind into the bracket, ensuring the chain is hanging directly down. Hook into place with a gentle downward motion. Repeat this process for the second roller blind. **NOTE:** PIN mechanism is spring loaded, you will need to gently push it in and then hook the mechanism side of the blind in. Our blind mounting brackets are identical so they can be used on either side of the window.



FIGURE 1:
PIN hole!

FIGURE 2: Control
mechanism holes!

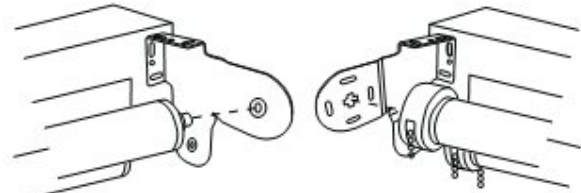

FIGURE 1

FIGURE 2

ILLUSTRATION

4. OPERATING THE BLIND

Now that your blinds are in position, using the chain draw the blinds down and up several times to ensure they operation successfully.

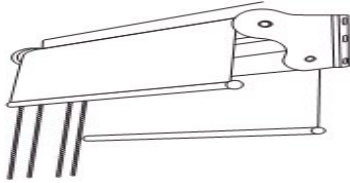

5. ATTACHING CHAIN CHILD SAFETY DEVICE

Secure the child safety device to the architrave. If you cannot secure it to the architrave, you should secure the child safety device to the wall. Ensure the chain is not tight as this may restrict smooth blind operation.



WARNING: THE CHAIN TENSION DEVICE MUST BE FITTED TO ENSURE CHILD SAFETY. IT IS TO BE POSITIONED AT THE BOTTOM OF THE CHAIN LOOP. IT CAN BE FITTED TO THE INSIDE OF THE WINDOW FRAME OR ON THE OUTSIDE OF THE WINDOW FRAME. IF, FOR SOME REASON, YOU CAN NOT FIT THE DEVICE TO THE WINDOW FRAME, YOU SHOULD MOUNT THE CHILD SAFETY DEVICE ON TO THE WALL.

FITTING INSTRUCTIONS:

1. POSITION THE TENSION DEVICE AT THE BOTTOM OF THE CHAIN LOOP AS SHOWN PER FIGURE 1.
2. USING APPROPRIATE SCREW, INSTALL THE TENSION DEVICE ONTO THE WINDOW FRAME, MAKING SURE THAT THE LOOP CHAIN HANGS WITH MINIMAL TENSION (AS SHOWN IN FIGURE 2) NOTE: Normally timber screw will be provided for the installation of the child safety device. Please use appropriate screws for the type of surface that you are securing child safety device onto i.e. metal, wood, aluminium etc...

← FIGURE 1

FIGURE 2 →



WARNING - ALL WINDOW COVERINGS WITH CORD OR CHAIN!

TO AVOID CREATING POSSIBLE STRANGULATION HAZARD FOR CHILDREN, THE CORDED OR CHAINED INTERNAL WINDOW COVERING MUST BE INSTALLED IN SUCH A WAY THAT A LOOSE CORD OR A CHAIN CANNOT FORM A LOOP 220mm OR LONGER AT A HEIGHT OF LESS THAN 1600mm ABOVE FLOOR LEVEL.

* A CORD/CHAIN GUIDE MAY BE INSTALLED LOWER THAN 1600mm ABOVE FLOOR LEVEL IF THE CORD CHAIN IS SUFFICIENTLY SECURED OR TENSIONED TO PREVENT A LOOP 220mm OR LONGER FROM BEING FORMED.

* IF A CORD/CHAIN GUIDE IS INSTALLED LOWER THAN 1600mm ABOVE FLOOR LEVEL, IT MUST BE DESIGNED TO PREVENT A CHILD FROM BEING ABLE TO REMOVE THE CORD/CHAIN.

* IF A CLEAT IS USED TO SECURE THE CORD, IT MUST BE AT LEAST 1600mm ABOVE FLOOR LEVEL BECAUSE A CHILD IS CAPABLE OF UNWINDING A CORD FROM A CLEAT.

